

337 – THREADED BALL CHECK VALVE



Properties

- FTF length according to drawing
- Threaded connection according to PN EN 10226-1:2006
- Leakage rate: class A
- Operational pressure PN16
- Medium temperature: 80°C
- The whole surface of the ball is covered by vulcanized rubber
- All parts are protected against corrosion
- GGG50 body
- Flange: PN16 up to DN150, PN10 above
- NBR/steel ball
- Epoxy coating RAL5005 250µm

Application

Waste water, technical water and other, not too aggressive fluids.

Installation

Horizontal and vertical positions.



Materials

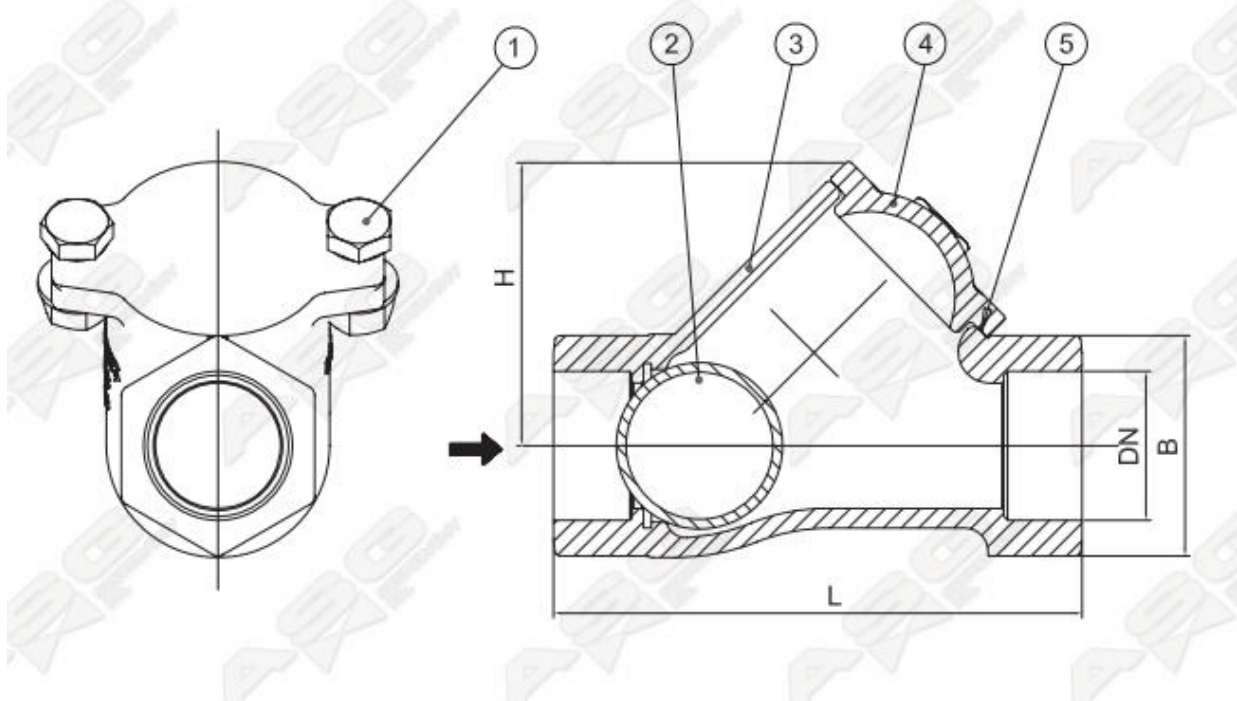

Item	Description	Materials
1	Bolt	Stainless steel
2	Ball	Steel+NBR
3	Body	GGG50
4	Bonnet	GGG50

Size (mm)

DN	Inch	L	B	H
25	1	120	45	64
32	1 1/4	135	50	72
40	1 1/2	145	60	85
50	2	175	70	100
65	2 1/2	200	90	125
80	3	248	108	160

Installation positions:

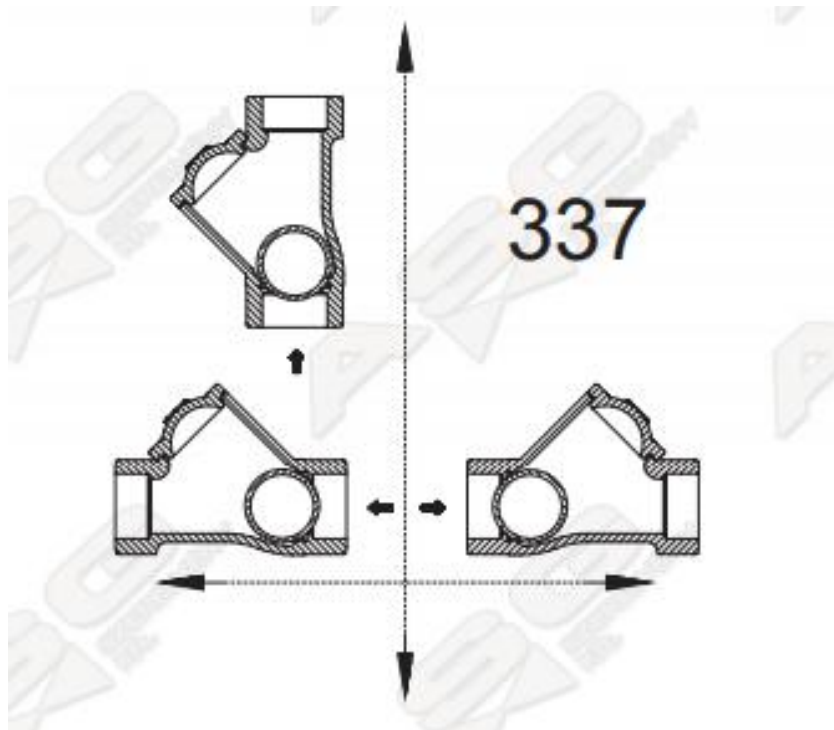

Pressure-performance diagram of 337 type valve

